

**Manifold
with 12 outlet ports
Type FR-12-...-B**
for 2n mounting frame

This component is used on mounting frames, as a manifold, or accumulator and as an additional reservoir for timers.

Accessories:

End cap for sealing off the barbed fittings

Order code 6213 CV-PK-3-B

Plug for G 1/4

Order code 3569 B-1/4

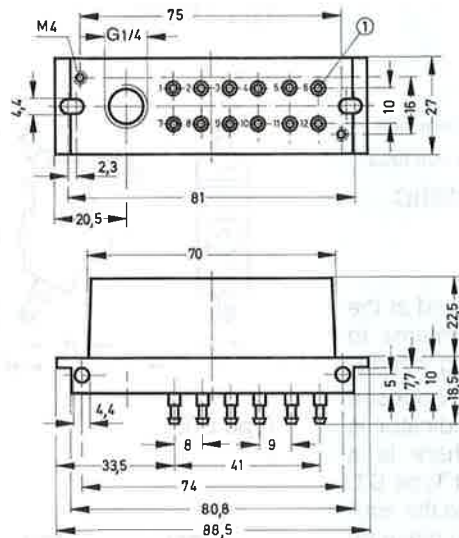

Order code	Part No./Type	8761 FR-12-PK-3-B	8762 FR-12-PK-4-B
Medium		Compressed air, filtered (lubricated or unlubricated)	
Mounting		Through-holes in housing or on mounting frame	
Connection	Supply line Outlet line	One G 1/4 connection 12 barbed fittings for 3 mm tubing	One G 1/4 connection 12 barbed fittings for 4 mm tubing
Pressure range		0 to 8 bar	
Temperature range		- 10 to + 60 °C	
Volume		22 cm ³	
Material		Polyamide	
Weights		0.065 kg	0.070 kg

**Manifold
Type FR-9-M3-B**

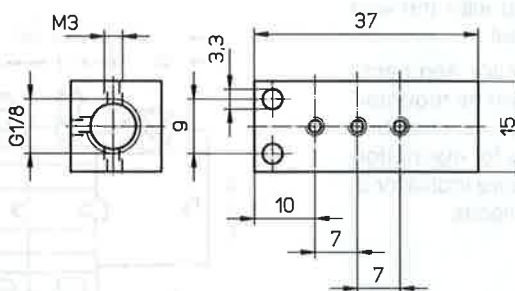

Order code	Connection	Material	Weight
Part No.	Supply line		
Type	Outlet line		
30981	G 1/8	Al, eloxiert	0.015 kg
FR-9-M3-B	M3		

**Manifold
Type FR-12-M 5**
with two common inlet ports*
and 12 outlet ports

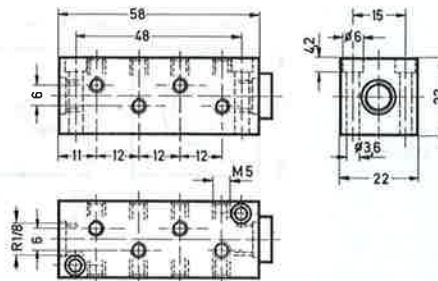

Order code	Part No./Type	4525 FR-12-M 5
Connection	Supply line: G 1/8; outlet ports: M 5	
Pressure range	0 to 16 bar	
Material	Anodized aluminium	
Weight	0.040 kg	

**Manifold
Type FR-4-...**
with four ports

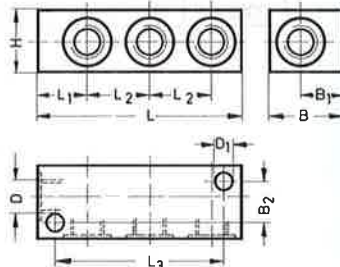

Pressure range			0 to 16 bar										
Order code		Connection D	Weight kg	Material	Dimensions								
Part No.	Type				B	B ₁	B ₂	D ₁	H	L	L ₁	L ₂	L ₃
6701	FR-4-1/8-B	G 1/8	0.025	Die-cast aluminium	20	11.6	13	4.4	17	56	13.5	17	46
7849	FR-4-1/4-C	G 1/4	0.060		28	17	16	6.4	30	89	20	29	74
6703	FR-4-3/8-B	G 3/8	0.075		32	19	20	6.4	26	85	20	26	72
6704	FR-4-1/2-B	G 1/2	0.120		38	22	25	6.4	32	105	25	32	90

**Manifold
Type FR-8-...**
with two common inlet ports*
and 8 outlet ports

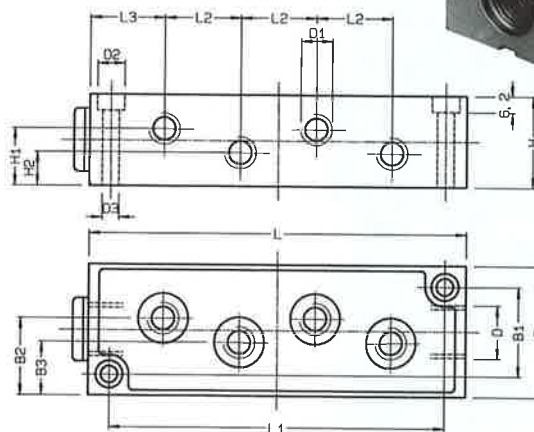

For manifold connector see overleaf

Pressure range			0 to 16 bar															
Order code		Connection D	D ₁	Weight kg	Material	Dimensions												
Part No.	Type					B	B ₁	B ₂	B ₃	D ₂	D ₃	H	H ₁	H ₂	L	L ₁	L ₂	L ₃
2077	FR-8-1/8	G 3/8	G 1/8	0.135	Die-cast aluminium	40	26	24.5	16.5	10.4	6.4	30	19.5	10.5	114	100	23	22.5
2078	FR-8-1/4	G 1/2	G 1/4	0.230	Die-cast aluminium	50	34	29.5	20.5	10.4	6.4	35	22	13	144	128	29	28.5
6411	FR-8-1/2	G 3/4	G 1/2	1.000	Anodized aluminium	60	40	33	27	15	9	45	25.5	19.5	170	150	36	31

* The second common inlet port is sealed with a plug